

@ COPYRIGHT
THIS DRAWING AND ANY DESIGN HEREON IS THE
COPYRIGHT OF **ROADMASTER CARAVANS LTD** AND **MUST**
NOT BE REPRODUCED WITHOUT THEIR WRITTEN CONSENT.

ALL DRAWINGS REMAIN THE PROPERTY OF:
ROADMASTER CARAVANS LTD.

NOTES:
ALL DRAWINGS TO BE READ IN CONJUNCTION WITH
ACCOMPANYING SPECIFICATIONS. ANY VARIATIONS OR
DISCREPANCIES TO BE REPORTED **IMMEDIATELY** TO THE
DESIGNER BEFORE ANY WORKS PROCEED.

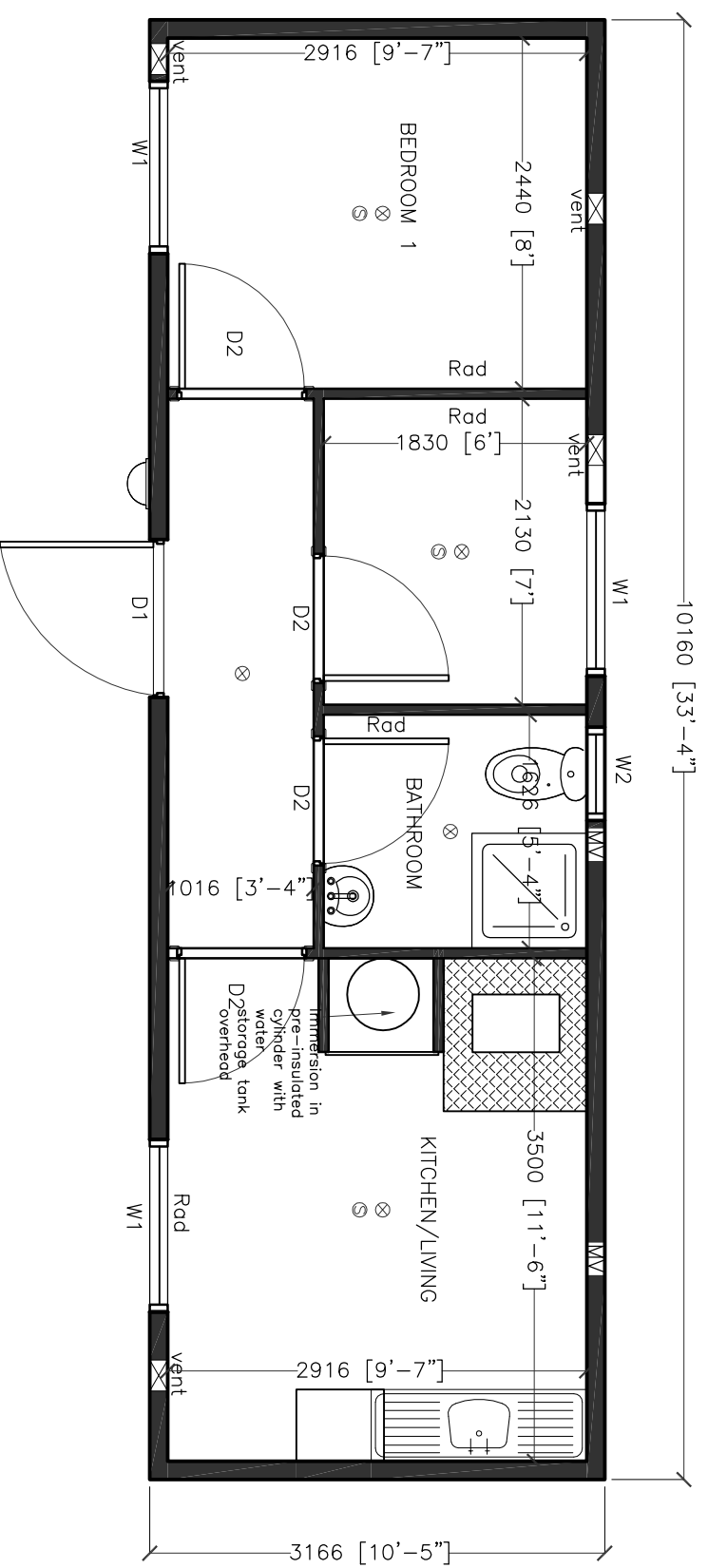

- ⊗ Light Location
- ⊙ Smoke Detector
- MV Mechanical Ventilation
- ⊗ Natural Ventilation
- ⊗ Non Combustible Material
- ⊗ Underneath Cooker/Heating Appliance

Windows	Doors	Heating
W1 1130x914mm high	D1 External Door Ope	Stanley 100 B Boiler-Fron HPB 100 B
W2 450x550mm high	D2 FD 30S with Smoke Seal	Stanley no 8 Solid Fuel - Mourne No 8 15K - Solid Fuel
All Double Glazed		Radiators 800x500 Singles

Proposed Ground Floor Plan 9.844M UNIT

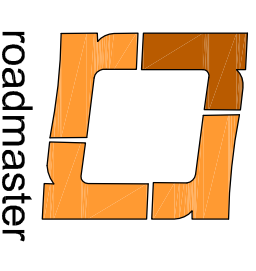

Roadmaster Caravans Ltd.

~ Roadmaster Caravans Ltd. ~
Johnstown (Via Thurles),
County Kilkenny
Rep. of Ireland
Tel: +353 56 8831201
Fax: +353 56 8831560
Email: info@roadmaster.ie

PROJECT:
**ROADMASTER CARAVANS LTD
DEMOUNTABLE DWELLINGS
FULLY SERVICED UNITS**

TITLE:
TYPE B 2 BEDROOM

DWG NO:
SK-101

SCALE:
1:50 (A3)

DATE:

REVISION :	DRAWN BY :	CHECK :
1st		